

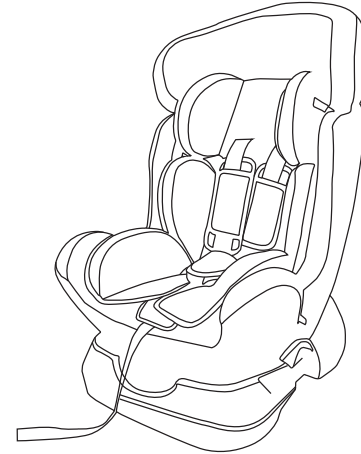

**R for Rabbit®**  
*The Amazing Baby Company*



**Manual Fitting Instructions for Child Car Seat Suitable for Age Group's 0,1 & 2 (0kg-25kg) Approx Age 0 Months to 7 Years**

Installation & User Manual

**JACK N JILL GRAND**  
**The Convertible Baby Car Seat**



**R for Rabbit®**  
*The Amazing Baby Company*

Designed & Marketed By **R FOR RABBIT BABY PRODUCTS PVT. LTD.**  
708, 7th Floor, Pinnacle Business Park, Corporate Road, Prahlad Nagar, Ahmedabad, Gujarat 380015  
For Customer Support: C: +91-79-410-57595 | W: [www.rforrabbit.com](http://www.rforrabbit.com) | E: [customercare@rforrabbit.com](mailto:customercare@rforrabbit.com)

### NOTICE

- 1.This is a “Universal” child restraint; it is approved to Regulation No.44,04 series of amendments, for general use in vehicles and it will fit most ,but not all, car seats.
- 2.A correct fit is likely if the vehicle manufacturer has declared in the vehicle handbook that the vehicle is capable of accepting a “Universal” child restraint for this age group.
- 3.This child restraint has been classified as “Universal” under more stringent conditions than those which applied to earlier designs which do not carry this notice.
- 4.If in doubt,consult either the child restraint manufacturer or the retailer.

Only suitable if the approved vehicles are fitted with 3-point safety-belts, approved to UN/ECE Regulation No.16 or other equivalent standards.

**EXTREME HAZARD**  
Do not use in passenger seats equipped with airbags (SRS)



! Do not install or use this child restraint until you closely read and understand the installation instructions provided by the child restraint manufacturer.

! Do not secure your child restraint in forward vehicle seating position equipped with airbag.

! Please pay attention to all the red stickers or red plastic parts on the seat, which are the belt routes for installation.

! Any straps holding the restraint to the vehicle should be tight, that any straps restraining the child should be adjusted to the child’s body, and that straps must not be twisted.

! Children can not be left in their child restraint system unattended.

! Ensuring that any lap strap is worn low down, so that the pelvis is firmly engaged, shall be stressed.

! The child restraint should be changed when it has been involved in an accident.

! Do not make any alteration or additions to the device without the approval of the competent authority.

! When the chair is not provided with a textile cover, the chair should be kept away from sunlight, otherwise it may be too hot for your child’s skin.

## Safety

! Any luggage or other subjects liable to cause injuries in the event of a collision must be properly secured.

! The child restraint must not be used without the cover.

! The seat cover should not be replaced with any other than the one recommended by the manufacturer, because the cover constitutes an integral part of the restraint performance.

! The instructions must be retained on the child restraint for its life period.

! Do not use any load bearing contact points other than those described in the instruction and marked in the child restraint.

! The rigid items and plastic parts of a child restraint must be located following this instruction and installed that they are not liable during everyday use of the vehicle to become trapped nu a movable seat or in a door of the vehicle.

! Children are not left in their child restraint system unattended

## Features

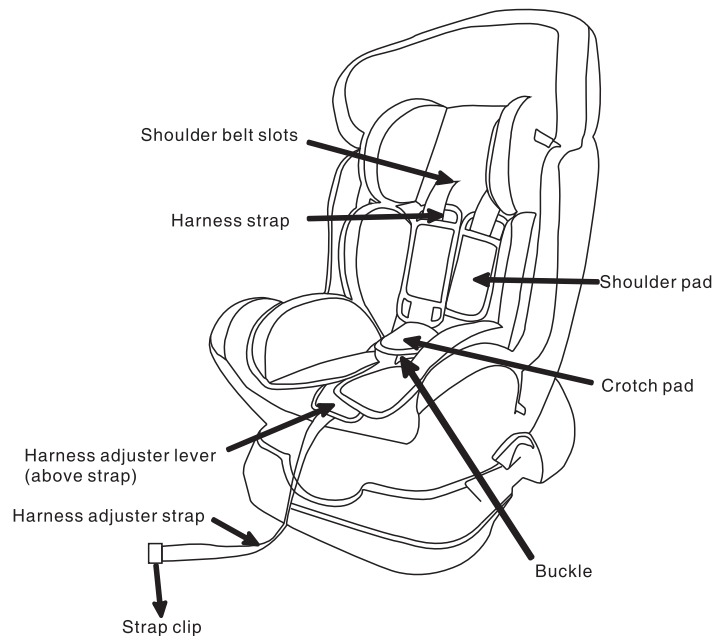

## Features

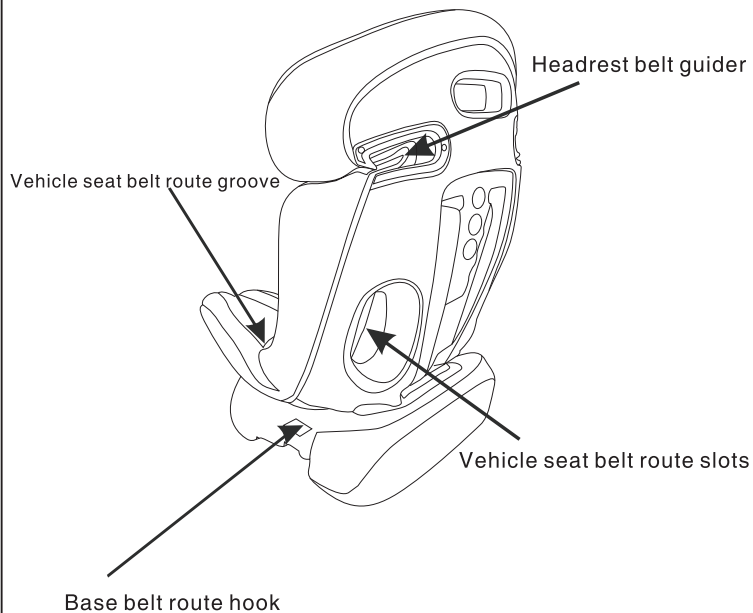

## Vehicle application

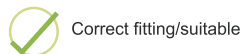

Correct fitting/suitable



Incorrect fitting/not suitable

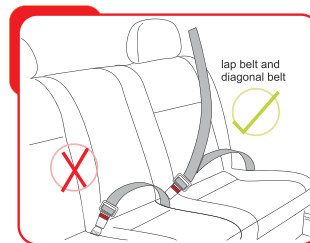

Lap and Diagonal belt  
Correct Fitting/Suitable



Lap belt  
Incorrect Fitting/Not Suitable

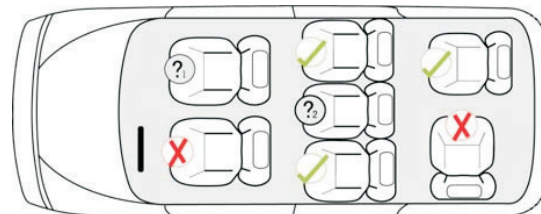

Do not use this child seat in seating position where an active front airbag installed



"Only suitable if the approved vehicle is fitted with 3 point safety-belts, approved to UN/ECE Regulation No.16 or other equivalent standards"

### CORRECT SHOULDER STRAP HEIGHT



NO-Too low



NO-Too high



Yes -Correct

Always check that the shoulder straps are at the correct height for your child. The child's shoulders should always be thread through the slots in the cover and seat shell that are closest to the top of your child's shoulders.

### CHANGING THE SHOULDER STRAP HEIGHT



Step1. Press the harness adjuster lever and pull both harness straps forward to create slack.

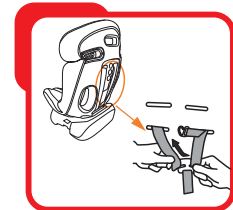

Step2. Turn seat around, from the rear of the seat remove straps from metal junction plate.



Step3. Pull straps ends through slots at front of seat and reinsert them in desired slots.

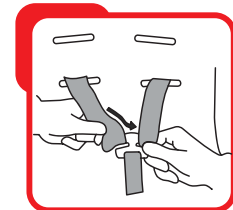

Step4. Check that harness straps are inserted into the same slots on each side of seat and make sure the straps are not twisted.

## Fastening the safety seat buckle

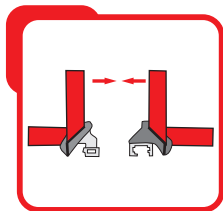

Step.1 Slot the two metal sections of the buckle connectors together.

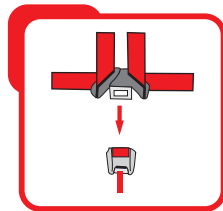

Step.2 Slot the two buckle connectors into the slot in the top of the buckle until they "click" into place.

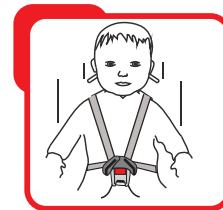

Step.3 Always check the harness is correctly locked by pulling the shoulder straps upwards.

To release the harness,press the red button on the buckle downwards.

## Tightening and slackening the harness Tightening the harness

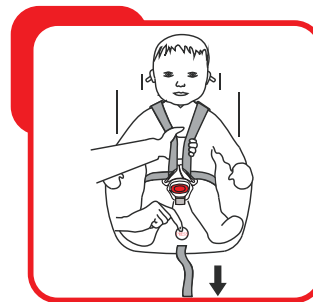
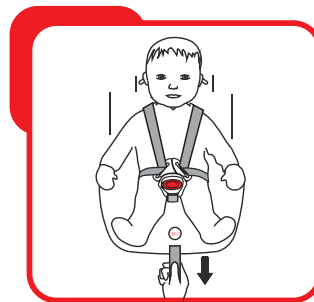

### ----Securing your child into the child restraint system

Adjust the harness system comfortably every time you place your child in the child restraint.

Step1.Place child into child restraint system.

Step2.Adjust the shoulder straps and headrest height(See items securing the child restraint system)

Step3.Check that no straps are twisted,put two metal parts together and slot into buckle.

Step4.Tighten the harness straight as tightly as possible without causing discomfort to your child.

**\*To release your child following the above instruction in the reverse order.**

## Important-keep the restraint rear-facing until The child's mass is great than 10kg

When the child seat is used for rearward facing position. The child seat must only be in the full reclined position. Please check the blue mark on the base of child seat for reference.

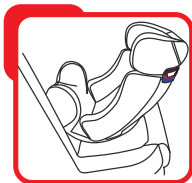

Step1. Place the child seat firmly against the back of forward-facing vehicle seat.

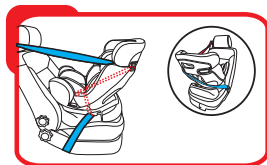

Step2. Pull the lap and diagonal section of the vehicle seat belt until fully extended and place the lap part through the base hook (from top to bottom) from one side and through the hook (from bottom to top) on the other side and then fasten the vehicle belt. Make sure that the lap belt is under the base. At the same time Place the diagonal belt into the headrest guider.

## Using for group 0 (0-10kg)

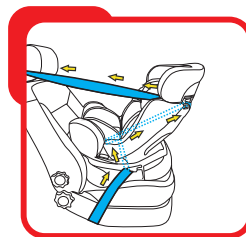

Step3. Tighten the vehicle seat belt by pulling first the lap section then the diagonal part along the direction as the picture shown. Make sure there is no twist in the vehicle belt.

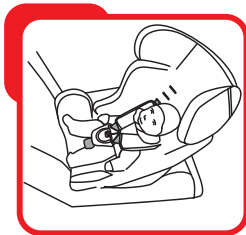

Step4. Place your child in the child car seat, make sure that the shoulder strap at the right height of your child.

Perform safety check for secure installation every time you drive with your child. Twist and pull child restraint forward and to both sides to make sure the vehicle belt does not lengthen or loosen and the child restraint does not easily move.

To release your child seat follow the above instructions in reverse order.

Attention: Only the most Angle of inclination fit for group 0.

## Using for group I (9-18kg)

When the child seat is used for forward facing position. Recline the child seat in your suitable position ( 1 or 2 ). Please check the Red mark on the base of the child seat for reference.



Step1. Place the child seat firmly against the back of forward-facing vehicle seat.

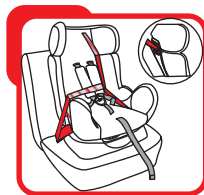

Step2. Pull the lap and diagonal section of the vehicle seat belt until fully extended, place the diagonal part of vehicle seat belt through the headrest guider while placing the lap belt through the groove marked red. Put 2 parts (diagonal and lap belt) into the slots passing from one side to the other side. Place the diagonal belt on the back while the lap belt is positioned into the groove before fastening the vehicle belt.

## Using for group I (9-18kg)

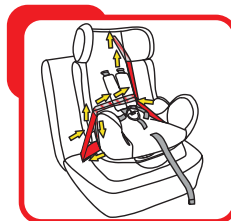

Step3. Tighten the vehicle seat belt by pulling first the lap section then the diagonal part along the direction as the picture shown. Make sure there is no twist in the vehicle belt.



Step4. Place your child in the child car seat , make sure that the shoulder strap at the right height of your child.

Perform safety check for secure installation every time you drive with your child Twist and pull child restraint forward and to both sides to make sure the vehicle belt does not lengthen or loosen and the child restraint does not easily move.

To release your child seat follow the above instructions in reverse order.

Attention: only 1,2 position fit for group1.



## Using for group II (15-25kg)

**IMPORTANT:** Before fitting the seat remove the shoulder straps, crotch strap and lap strap.



Step 1. Place the child seat firmly against the back of forward-facing vehicle seat.



Step 2. Place your child in the child seat, make sure that your child's back is flat against the back of child seat. Pull out of the 3 point vehicle seat belt and place the diagonal belt goes through the headrest guider while lap belt through the groove marked red. Make sure both diagonal and lap parts go through the groove marked red on the other side before fasten the vehicle belt.



Step 3. Tighten the vehicle belt by pulling first the lap section then the diagonal part along the direction as the picture shown. Make sure there is no twist in the vehicle belt.

Perform safety check for secure installation every time you drive with your child. Twist and pull child restraint forward and to both sides to make sure the vehicle belt does not lengthen or loosen and the child restraint does not easily move.

To release your child seat follow the above instructions in reverse order. Attention: only 1 position fit for group 2.

## Cleaning & maintenance

These instructions are important. Please read carefully and retain for future reference.

Remove the harness system.  
Remove the seat cover.  
To replace the cover please reserve the producer.

**Important:** The cover is a safety feature. Never use the child seat without it. Don't put your child's safety at risk by using other makes of replacement cover, could stop the child seat from protecting your child as well as it should.

Washing instruction:

The cover is removable and washable at 30°C, line dry only.



Machine wash, cold



Do not bleach



Dry clean, any solvent except Trichloroethylene.



Do not tumble dry



Do not iron

If in doubt, consult either the child restraint manufacturer or the retailer.



European safety standard