



Imported & Marketed By:

R FOR RABBIT BABY PRODUCTS PVT. LTD.

Add: 708, 7th Floor, Pinnacle Business Park, Corporate Road,

Prahlad Nagar, Ahmedabad, Gujarat 380015

C: +91-79-410-57595 | W: www.rforrabbit.com

E: customercare@rforrabbit.com

Scan & Search
"Marshmallow"
for Installation

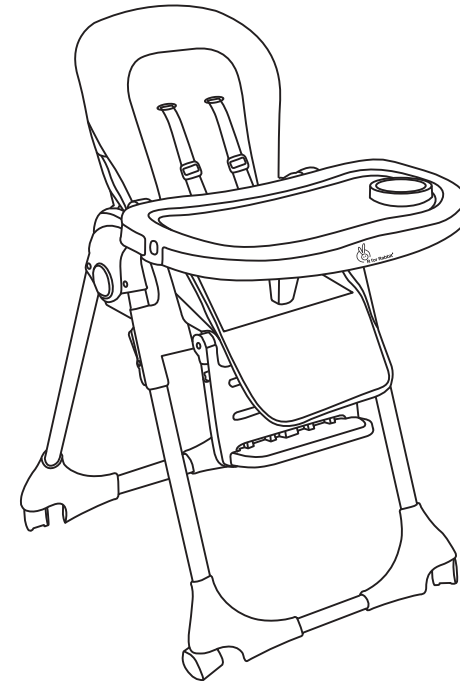

*Picture shown is for illustrative purpose only.
Actual product may vary from image.

MARSHMALLOW

The Smart High Chair



Installation & User Manual

Read the instructions carefully before using the stroller and keep this manual for future reference.

Note: The safety your child and product can be compromised if the instructions stated in manual aren't thoroughly followed.

Installation Instructions

1. Your new Marshmallow high chair is a smart chair with removable components. Please review parts list below. Chair is easy to store and can be assembled and disassembled when needed.

- ① Seat
- ② Double Tray
- ③ Footrest
- ④ Foot plate



2. Unfold the seat, press the red button and lower both the arm rests on both sides as shown in picture.



①



②

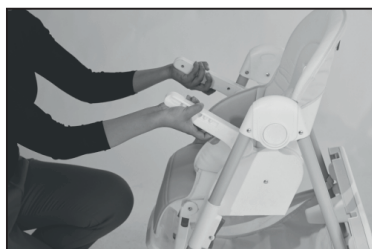

③



④

3. Using both hands, insert the meal tray as shown below.

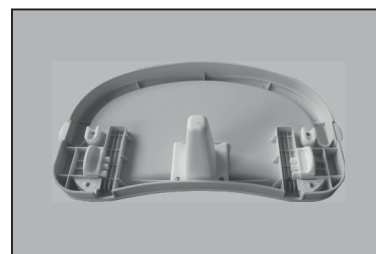

①



②



③



④

4. Insert the foot rest as shown and then insert the foot plate.



①



②



③



④

5. Marshmallow is height adjustable and can be used by children from the ages of 6 months to 5 years. Please review illustration below to decrease/increase height of your high chair.

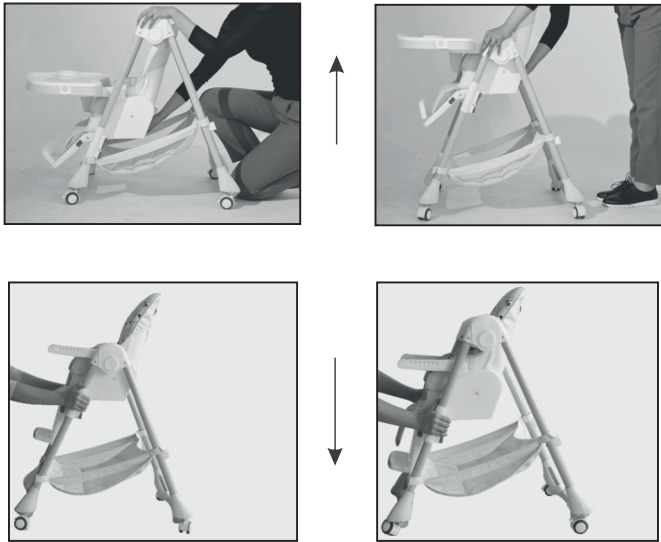

6. Your high chair has a smart adjustable back-rest. Locate the red button on the back of the back-rest and press it to find a position that is comfortable for your baby. Back-rest supports 3 seating positions.



7. Marshmallow is an advanced high chair designed to give the most comfortable seating position to your baby. It supports 3 foot-rest positions. Press the left and right red button as shown in illustration below to adjust foot-rest position.



8. The smart tray can be adjusted to fit with each of those modes. There are 3 positions available as shown below.



9. Smart one button fold.

Locate buttons on the left and right side that look like white dots as shown in picture. Press them and push forward the back of chair with your feet. The tray should hang on the back of your chair as illustrated.



10. Using the 5-point harness

To unbuckle, press the red arrow as shown. Once your baby is comfortably seated on the chair, buckle up the safety belt.

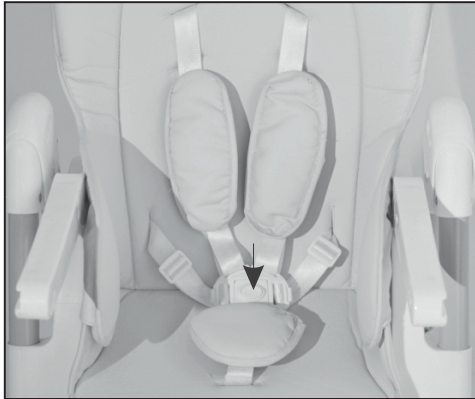

11. Locking the wheels

For safety reasons, always ensure wheels are locked in position when your baby is seated. Button upward means unlocked. Button down means locked.

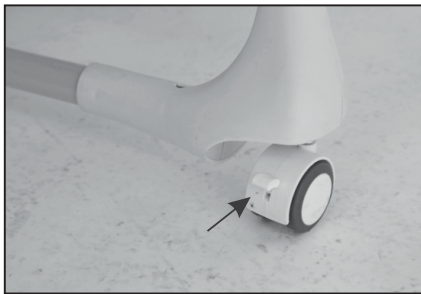

1



2

WARNING

1. Never leave your child unattended
2. Do not use the high chair unless all components are correctly fitted & adjusted
3. Always ensure to fasten the safety harness
4. Do not use the chair near open fire and heating devices
5. Do not use the high chair until your child starts to sit without assistance
6. Do not use the high chair if there is a broken, damaged or missing part
7. Periodically check the buttons and harness system for safety
8. Always use the chair on a flat even surface
9. When not in use keep the chair away from children
10. Please ensure that the high chair has been assembled correctly by following this instruction sheet. Failure to do so can cause harm to your child
11. Do not allow your child to stand up whilst in the chair
12. Ensure your high chair is fully erected before placing your child inside
13. Regularly check all parts for wear and tear
14. Please retain this manual for future reference
15. Please ensure that the high chair is assembled by an adult

CLEANING & CARE INSTRUCTIONS

- Clean all fabrics with mild soap & warm water. Let it dry naturally. Do not dry in direct heat source or direct sun.
- Please clean heavy dirty spots with non-abrasive cream
- Oil all movable parts regularly